

# Drop-in anchor

## SA 12D

## SA-N

### Advantages



Drop-in anchor SA 12D, zinc plated  
Drop-in anchor SA-N, stainless steel A4



Setting tool ESW PRO



Setting tool ESW

- SA 12D with the reinforced anchor sleeve is especially suitable for temporary fastenings of diamond core rigs.
- SA-N is made of stainless steel A4, therefore the anchor has a high corrosion resistance and can be used for outdoor applications.
- The high expansion ability of the drop-in anchor enables a low anchorage and drill hole depth.
- For a correct and fast installation it is essential to use the setting tool ESW or ESW Pro with hand protection to achieve a high expansion and secure anchorage in the base material.

### Suitable building materials

#### Very suitable



- Concrete



### Approvals and certificates



### Mounting

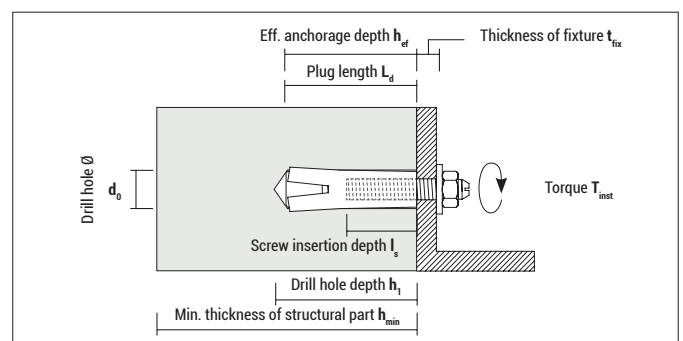
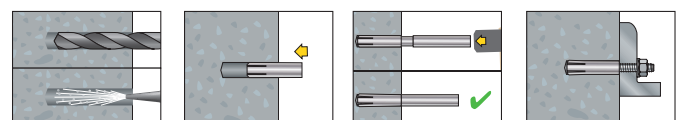

## Drop-in anchor SA and SA N



**SA 12D, zinc plated** without approval, recommended for fixing diamond core rigs

Type	Art-No	d <sub>0</sub> * [mm]	h <sub>1</sub> [mm]	L <sub>d</sub> [mm]	l <sub>s min-max</sub> ** [mm]	Thread	€/100 pcs	[pcs]	[pcs]
SA 12D	91216SA	16	50	50	12 - 18	M12		50	250

\* reinforced anchor sleeve by 1 mm

\*\* Min. / max. screw insertion depth in drop-in anchor



**SA-N, stainless steel A4** without approval

Type	Art-No	d <sub>0</sub> [mm]	h <sub>1</sub> [mm]	L <sub>d</sub> [mm]	l <sub>s min-max</sub> * [mm]	Thread	€/100 pcs	[pcs]	[pcs]
SA-N 6	9X6SAN	8	25	25	6 - 12	M6		100	1.000
SA-N 8	9X8SAN	10	30	30	8 - 13	M8		100	1.000
SA-N 10	9X10SAN	12	40	40	10 - 15	M10		50	500
SA-N 12	9X12SAN	15	50	50	12 - 18	M12		50	400
SA-N 16	9X16SAN	20	65	65	16 - 23	M16		25	125

\* Min. / max. screw insertion depth in drop-in anchor



**ESW** for SA plus, SAK plus, SA and SA-N

Type	Art-No	Suitable for	€/pcs	[pcs]
ESW 6	96ESW	SA plus 6, SAK plus 6, SA-N 6		1
ESW 8	98ESW	SA plus 8, SAK plus 8 and SAK plus 8-25, SA-N 8		1
ESW 10	910ESW	SA plus 10, SAK plus 10 and SA-N 10		1
ESW 12	912ESW	SA plus 12, SAK plus 12 and SA 12D, SA-N 12		1
ESW 16	916ESW	SA plus 16, SAK plus 16 and SA-N 16		1

Setting tool ESW PRO with hand protection see page 115

## Loads, spacing and edge distance in non-cracked concrete

Type	Concrete C20/25 F <sub>rec</sub> [kN]	Spacing S <sub>min</sub> [mm]	Edge distance C <sub>min</sub> [mm]	Min. thickness of structural part h <sub>min</sub> [mm]	Max. Torque T <sub>inst</sub> ≤ [Nm]
SA-N 6	1,2	70	80	100	5
SA-N 8	1,8	90	90	100	8
SA-N 10	3,6	120	120	120	15
SA/SA-N 12	5,7	160	160	150	35
SA-N 16	7,4	220	240	200	60

F<sub>rec</sub>: Recommended loads incl. safety factor of 4